

We hope that you have had a good summer. We are looking forward to welcoming all children back to school on Wednesday 1st September.

We have waited until now to inform you of the arrangements for the autumn term so that we could ensure that we were up to date with the current government guidance.

I am really pleased to say that we are able to return to a more normal way of working in September. In the last 18 months we have had to change the way we have done many things. As there are less restrictions now, we are able to move away from many of the procedures we put in place but we will keep some of the changes we made which have been successful and beneficial. This means that at playtime and lunchtime, children will be mixing across classes and year groups, we do not have to keep classes separate any more or send a whole class home if there is a positive case. However, we do still have precautions in place e.g. regular hand washing/sanitising and extra ventilation. We remain vigilant and have a Local Authority approved Risk Assessment if an outbreak does occur. It's important that we all play our part in this and if your child is not well then please don't send them to school – see the end of this letter for further details.

The following sets out our new arrangements:

We will operate a free flow start to the day – all children are invited to come in to school between 8:40 and 8:50.

It is important that all children are in school by 8:50. The gate will be locked after this time and will therefore cause an inconvenience to yourself as well as your child if you come later than this as teaching will commence promptly. Any children arriving after the gate is locked risk being marked down as late.

From September we are operating a one-way system for all adults & children entering the school grounds:

Entrance to school

Main entrance

Exit from school

Pupil exit – between Activity Den and School House

<p>Start of the school day</p>	<p>Free flow start to the day – children should arrive between 8:40 and 8:50. If you are bringing more than one child, follow our one-way system by dropping off Y1 and Y2 children first, then Reception and Pre-School children and finally Y3 and Y4 children.</p> <p>Y5 and Y6 children should come into school without any parents.</p> <p>The entry gate will be opened at 8:35 and then locked at 8:50. Anyone coming in after this will have to come to the main office to gain entrance and marked as late on the register.</p>
<p>Route for RD Mr Durham's class</p>	<p>Through main entrance, left through the cage, up to Mr Durham's Fire Exit door. Parents leave via exit between Activity Den and School House.</p> <p><i>See photo at the end of this letter for a diagram of this.</i></p>

<p>PE Kits</p>	<p>All children from Reception to Y6 (Pre-School don't have PE Kits)</p>	<p>On PE days the children should come in their PE kit instead of their school uniform. This means that they will have more time for the actual PE lesson.</p> <p>We'll let you know the children's PE day once the teachers have decided this.</p>
-----------------------	--	---

End of the school day		
Entrance to school at end of the day	Gate will be opened at 3:00	Same one-way system: Entrance Main entrance Exit Pupil exit – between Activity Den and School House
Mr Durham's RD	Pick up at 3:05	Parents enter same way as the morning – line up on the lines which run alongside Mr Durham's classroom and wait for the teacher to see you and send your child out to you. Leave via exit between Activity Den and School House.

Catch Up on a Wednesday

We will be continuing this until further notice as we have funding left over from the January – March 2021 period when we were unable to offer this. We are waiting to see if there will be any additional funding to continue this after October half term. This half term the end of the school day will therefore be one hour later on a Wednesday. We will start this on Wednesday 8th September. *For those parents of Reception children who are new to our school, I will phone you once we return to school to explain this.*

The government continue to issue guidance re Covid and regulations have changed regarding isolation etc. The following is now what we are being instructed to do:

Your child must attend school unless they are ill.

From 16th August 2021, children under 18 (or double-vaccinated adults) do not need to self-isolate or miss school if a member of their household or a contact, has Covid.

Instead, they will need to book a PCR test but can continue coming to school until they get the test result, as long as they have no symptoms.

When should your child not attend school?

If your child develops Covid symptoms at home, they should stay at home and book a PCR test (not a Lateral Flow Test).

If your child develops Covid symptoms at school, they will be sent home and you should book them a PCR test.

If your child tests positive for Covid they will need to self-isolate. The rest of the household does not need to self-isolate if they are under 18 or fully vaccinated, but they should book a PCR test. As above, anyone who has **no** symptoms but has taken a PCR test CAN still attend school whilst waiting for the result.

It is not a requirement for children to take a Lateral Flow Test.

It continues to be important that if your child has to go for a PCR test, please inform us of this via our school email address – tanfieldlea@durhamlearning.net - and of the result when you have this. Although schools are no longer required to 'Track and Trace' we are still expected to have this information and may be contacted by Public Health to assist them.

Regarding masks, we no longer require adults to wear masks when bringing their child to school. We only request them to be worn if adults are coming into school and meeting in close proximity with other adults.

I think that's all you need to know for the start of term.

I hope you find the following diagram useful in showing how to enter and exit the site from Wednesday. We look forward to welcoming you all on Wednesday 1st September.

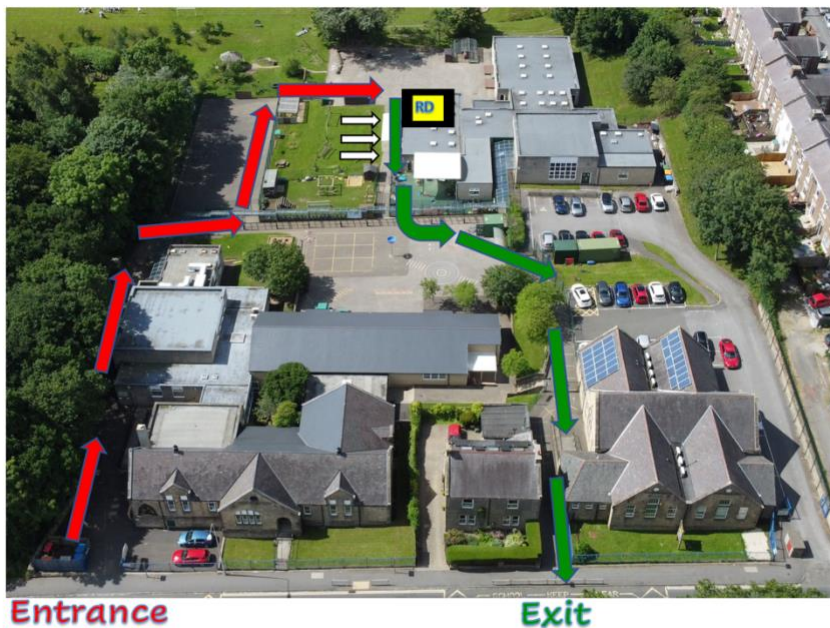

When picking your child up at the end of the day, please line up where the white arrows are pointing on the photo and Mr Durham will bring your child out.

Red is how you enter school and get to your child's classroom 
Green is how you exit school 

Yours sincerely,

Kay Hemmings
Head Teacher